



STREET DEFENDER CURB

RubberForm's modular Street Defender system prevents "street takeovers" or "sideshows" from shutting down public intersections. Without intervention these street car exhibitions can cause traffic accidents, damage to property, injury, and even death for those driving or watching. Using the same rugged rubber curbs we use to protect bus and bike lanes, you can prevent street takeovers while allowing normal traffic to flow. Our curbs are simple to install: no heavy equipment, no road closures, no large crews. And they'll last decades, enduring all the heat, cold, rain, ice, snow, and heavy traffic you can throw at them.

KEY FEATURES:

MADE IN THE USA

with 100% recycled rubber and plastic composite material

STRONG

Will not chip, crack, spall or corrode

DURABLE

Withstands heavy traffic impacts

FLEXIBLE

conforms to road curvature and any asphalt or concrete surface

HIGH

enough to deter drifting

VERSATILE APPLICATIONS

Easy to install, remove, and relocate - for semi-permanent to permanent use

THERMOPLASTIC REFLECTIVE MATERIAL

Made in the USA



100% Recycled Materials



Increase LEED Score



STREET DEFENDER CURB SPECIFICATIONS

RUBBERFORM RF-BLC40YLW/WHT (CENTER MODULE)

- A 5/8" Masonry Drill Bit is needed to drill proper holes
- A 3/4 Nut Drive will be needed to secure the bolts to the lag anchor



HARDWARE KIT

RF-BLC40HWK

- 4-1/2"x8" LagBolts
- 4-1/2"x1-1/16" Washers
- 4-1/2"x3" Anchors
- 4 Black Rubber Caps
- 1 Dual Flange Connector

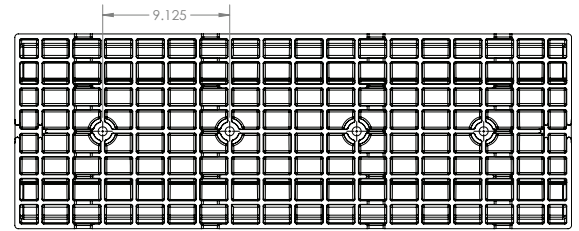
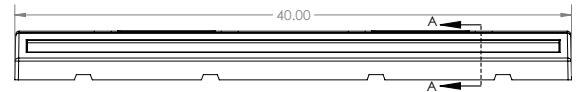
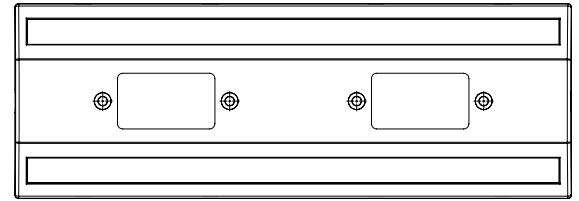

RUBBERFORM RF-BLCECYLW/WHT (END CAP)

- 3.5 lbs
- 3.5"H x 14"W x 14"L
- Injection Molded
- 3 mounting holes
- 1 large yellow or white reflective stripe



HARDWARE KIT

RF-BLCECHWK

- 3-1/2"x8" LagBolts
- 3-1/2"x1-1/16" Washers
- 3-1/2"x3" Anchors
- 3 Black Rubber Caps
- 1 Dual Flange Connector

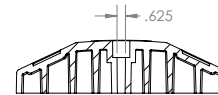

SECTION A-A
SCALE 1 : 6

